



# TRADITIONS

---

## 2011 RANCH HOMES



# Sectional

## 2011 Standard Features

### INTERIOR

- Standard Drape Package with 2" Blinds
- Calaber Carpet with Rebond Pad & Tackstrip - Living Room & All Bedrooms
- 8' Flat Ceiling Throughout
- Taped Ceiling Joints T/O
- Stipple Textured Ceiling
- 1/2" Drywall Throughout
- Colored Accent Wall in Kitchen
- Wire Vented Shelving – Closets
- Prairie Embossed Interior Passage Doors
- Furnace Close-off Door
- Water Heater Close-off Door
- Attic Access w/Optional 5/12 Roof Pitch
- 32" Interior Doors at Bedrooms, Baths and Utility Room
- Oil Rubbed Bronze interior door knobs and hinges
- Glidden Egg Shell Builder Grade Paint T/O

### KITCHEN

- Hickory Cabinets w/Flat Panel Doors & MDF Stiles
- Drawer Over Door Cabinet Construction
- Refrigerator Overhead Cabinet
- 30" Overhead Cabinets with Finished Backs
- Bank of Drawers
- Residential Metal Drawer Guides
- Oil Rubbed Bronze Cabinet Door Knobs & Drawer Pulls
- Concealed Cabinet Door Hinges
- 8" Stainless Steel Sink
- CFG Single Lever Kitchen Faucet
- High Pressure Laminated Countertops with 4" Laminate Backsplash
- Receptacle with Ground Fault Interrupter
- Recessed Can Lights with Separate Switch
- Pot and Pan Drawer

### APPLIANCES

- 30" Electric Range
- 18 Cu. Ft. 2-Door Frost Free Refrigerator with Icemaker
- Power Range Hood with Light
- 40 Gallon Electric Water Heater

### BEDROOMS

- Smoke Detector in Sleeping Areas
- Egress Window - Each Bedroom
- Ceiling Light - Each Bedroom

### BATHS

- 60" Fiberglass Tub/Showers
- CFG Single Lever Anti-Scald Tub/Shower Faucets
- 36" Vanity Height - Master Bath
- 32" Vanity Height - Bath 2
- Mirror Over Vanity with Decorative Light - Each Bath
- Bottom Shelf in Bath Vanity
- Elongated Porcelain Commodes
- Receptacle with Ground Fault Interrupter
- Power Bath Fan - Each Bath
- Porcelain Lavs with Pop-up Drain

### UTILITIES

- 200 Amp Entrance Service with Conduit Through Floor
- Electric Furnace
- Beauty Ring Seals - All Commodes
- Pex Plumbing lines
- Brass Plumbing Fittings
- Copper Wiring Throughout - Fully Grounded
- Wire & Plumb for Washer
- Wire & Vent for Dryer
- Recessed Whole House Water Shut-Off
- Water Shut-offs - Kitchen Sink, Lavs, Commodes
- Vented Wire Shelf in the Laundry Area
- Water heater pan with exterior drain

### INSULATION

- Kraft Back Fiberglass Insulated Heat Duct (Saves up to 18% in Energy Costs)

- \*R-30 Blown Ceiling Insulation with Vapor Barrier
  - \*R-19 Fiberglass Insulation in Walls
  - \*R-11 Fiberglass Insulation in Floors
- \*The higher the R-Values, the greater the insulating power

### EXTERIOR

- 3/12 Roof Pitch
- Ply Dry shingle underlayment
- Metal fascia
- Vinyl Vented Soffit
- Vinyl Wrapped Brickmold
- 36" Vinyl Clad Steel Front Door with Deadbolt
- 32" Vinyl Clad Steel Rear Door with Deadbolt
- Keyed Alike Contractor Locksets
- Exterior Light at All Exterior Doors
- 25 year 3 tab shingles
- Traditional Double 4 Vinyl Siding
- Raised Panel Shutters - Front Door Wall
- Single Hung Vinyl Windows with Removable Tilt Sash-Low E Glass, Grids and Screens
- OSB Exterior Wall Sheathing
- Windwrap over OSB exterior wall sheathing
- Exterior GFI recept
- Exterior Faucet
- Exterior Porch - 8" Square Cemplank Post with Railing

### CONSTRUCTION

- Steel I-Beam Frame with Detachable Hitch
- 2"x6" Floor Joists 16" O.C. - 27' Wide
- 2"x8" Floor Joists 16" O.C. - 30' Wide
- 19132 T&G OSB Floor Decking Glued & Fastened
- 2"x6" Exterior Walls - 16" O.C.
- Roof Truss - 24" O.C.
- Ridge Vent Roof Venting
- Linked smoke detectors with battery back-up
- 10 yr Structural Warranty

# Modular

## 2011 Standard Features

### INTERIOR

- Standard Drape Package with 2" Blinds
- Calaber Carpet with Rebond Pad & Tackstrip - Living Room & All Bedrooms
- 8' Flat Ceiling Throughout
- Taped Ceiling Joints T/O
- Stipple Textured Ceiling
- 1/2" Drywall Throughout
- Colored Accent Wall in Kitchen
- Wire Vented Shelving – Closets
- Prairie Embossed Interior Passage Doors
- Furnace Close-off Door
- Water Heater Close-off Door
- Attic Access
- 32" Interior Doors at Bedrooms, Baths and Utility Room
- Oil Rubbed Bronze interior door knobs and hinges
- Glidden Egg Shell Builders Grade Paint T/O

### KITCHEN

- Hickory Cabinets w/Flat Panel Doors & MDF Stiles
- Drawer Over Door Cabinet Construction
- Refrigerator Overhead Cabinet
- 30" Overhead Cabinets with Finished Backs
- Bank of Drawers
- Residential Metal Drawer Guides
- Oil Rubbed Bronze Cabinet Door Knobs & Drawer Pulls
- Concealed Cabinet Door Hinges
- 8" Stainless Steel Sink
- CFG Single Lever Kitchen Faucet
- High Pressure Laminated Countertops with 4" Laminate Backsplash
- Receptacle with Ground Fault Interrupter
- Recessed Can Lights with Separate Switch
- Pot and Pan Drawer

### APPLIANCES

- 30" Electric Range
- 18 Cu. Ft. 2-Door Frost Free Refrigerator with Icemaker
- Power Range Hood with Light
- 40 Gallon Electric Water Heater

### BEDROOMS

- Smoke Detector in Sleeping Areas
- Egress Window - Each Bedroom
- Ceiling Light - Each Bedroom

### BATHS

- 60" Fiberglass Tub/Showers
- CFG Single Lever Anti-Scald Tub/Shower Faucets
- 36" Vanity Height - Master Bath
- 32" Vanity Height - Secondary Baths
- Mirror Over Vanity with Decorative Light - Each Bath
- Bottom Shelf in Bath Vanity
- Elongated Porcelain Commodes
- Receptacle with Ground Fault Interrupter
- Power Bath Fan - Each Bath
- Porcelain Lavs with Pop-up Drain

### UTILITIES

- 200 Amp Service w/Circuit Breakers (per plan)
- Electric Furnace
- Beauty Ring Seals - All Commodes
- Pex Plumbing lines
- Brass Plumbing Fittings
- Copper Wiring Throughout - Fully Grounded
- Wire & Plumb for Washer
- Wire & Vent for Dryer
- Recessed Whole House Water Shut-Off
- Water Shut-offs - Kitchen Sink, Lavs, Commodes
- Vented Wire Shelf in the Laundry Area
- Water heater pan with exterior drain

### INSULATION

- Kraft Back Fiberglass Insulated Heat Duct (Saves up to 18% in Energy Costs)

- \*R-30 Blown Cellulose Insulation in Ceiling
- \*R-19 Fiberglass Insulation in Walls
- \*The higher the R-Values, the greater the insulating power

### EXTERIOR

- 3/12 Roof Pitch
- Ply Dry shingle underlayment
- Metal fascia
- Vinyl Vented Soffit
- Vinyl Wrapped Brickmold
- 36" Vinyl Clad Steel Front Door with Deadbolt
- 32" Vinyl Clad Steel Rear Door with Deadbolt
- Keyed Alike Contractor Locksets
- Exterior Light at All Exterior Doors
- 25 Year 3 Tab Shingles
- Traditional Double 4 Vinyl Siding
- Raised Panel Shutters - Front Door Wall
- Single Hung Vinyl Windows with Removable Tilt Sash Low E Glass, Grids and Screens
- OSB Exterior Wall Sheathing
- Windwrap over OSB exterior wall sheathing
- Exterior GFI recept
- Exterior Faucet
- Exterior Porch - 8" Square Cemplank Post with Railing

### CONSTRUCTION

- 2"x10" Floor Joists 16" O.C.
- Double Rim Joist - Front and Rear
- 19/32" T&G OSB Floor Decking Glued and Fastened
- 2"x6" Exterior Walls - 16" O.C.
- Double 2"x6" Top Plate and Single Bottom Plates
- Roof Truss - 24" O.C. (30# Snow Load)
- Ridge Vent Roof Venting
- Linked smoke detectors with battery back-up
- 10 yr Structural Warranty

# Index

Model Name	Model Number	Square Feet	Floor Width	Beds	Baths	Page
Arlington	6428-12-1	1714	27'-0"	3	2	25
Aspen	5228-404-1	1404	27'-0"	3	2	13
Blairwood	6430-43	1920	30'-0"	3	2	26
Brighton	5028-32-5	1350	27'-0"	3	2	12
Carrington	7630-1170-1	2280	30'-0"	3	2	30
Cedar Knoll	6028-609-1	1620	27'-0"	3	2	21
Countryside	6028-1157-1	1620	27'-0"	3	2	23
Diamondwood	5428-49-3	1458	27'-0"	3	2	16
Hartford	6828-82-1	1725	27'-0"	3	2	27
Knollwood	7630-1173	2280	30'-0"	4	2	28
Laurelwood	4828-405-1	1296	27'-0"	3	2	7
Meadow View	5630-1012-1	1680	30'-0"	3	2	19
Pheasant Ridge	5228-75-1	1404	27'-0"	3	2	15
Ridgewood	6028-1050-1	1620	27'-0"	3	2	22
River Glen	7630-35-1	2280	30'-0"	4	3	29
Sharonwood	6428-406-1	1728	27'-0"	3	2	24
Shenandoah	4828-1174-1	1296	27'-0"	3	2	8
Sheridan	5628-92-2	1511	27'-0"	3	2	17
Stonebrook	4841-1175	1633	27'-0"	3	2	10
Trenton	5228-1149-1	1404	27'-0"	3	2	14
Vandalia	5630-1152	1680	30'-0"	3	2	20
Westchester	4428-401-1	1188	27'-0"	3	2	6
Wyatt	5628-8045	1511	27'-0"	3	2	18
2011 Sectional Standard Features						2
2011 Modular Standard Features						3
Optional Room Extensions and Flex Baths						31

## Key

DW.....	Dishwasher
P&P.....	Pots & Pan Drawer
● .....	Glass Doors
ES.....	Electric Service
----- .....	1 Shelf (Closet or Entrance Closet)
----- .....	Double Closet Shelf
----- .....	4 Shelves (Linen or Pantry)
SHLVS.....	4 Open Shelves (per model)
DWR.....	Bank of Drawers



Founded in 1934, Schult continues its rich tradition of home building. At Schult we have dedicated ourselves to build affordable homes of the highest quality and integrity. Craftsmanship and satisfied homeowners has been our goal for 76 years.



**For all those traditions that  
make a house your home.**



# Westchester

MODEL 4428-401-1

1188 SQUARE FEET • 3 BEDS / 2 BATHS



OPTIONAL BASEMENT STAIRWELL  
MOD ONLY



OPTIONAL DEN  
(REPLACES BEDROOM #2)

# Laurelwood

MODEL 4828-405-1

1296 SQUARE FEET • 3 BEDS / 2 BATHS



OPTIONAL BASEMENT STAIRWELL  
MOD ONLY

# Shenandoah

MODEL 4828-1174-1

1296 SQUARE FEET • 3 BEDS / 2 BATHS



Model 4828-1174-1



Model 4841-1174P-1



DELUXE MASTER BATH OPTION



MASTER BATH OPTION w/  
SEATED SHOWER



SIGNATURE KITCHEN OPTION WITH SURFACE  
COOK-TOP, BUILT-IN OVEN & MICROWAVE



OPTIONAL BASEMENT STAIRWELL  
MOD ONLY



# Shenandoah

**3/12 Roof Pitch** Craftsman Color Packages



**5/12 Roof Pitch** Craftsman Color Packages



**7/12 Roof Pitch** Craftsman Color Packages



## Typical Roof Pitch Selections

- 3/12, 5/12 and 7/12 Roof Pitch Available In All Models
- Renderings Displayed In Craftsman Exterior Color Packages A, B and C

# Stonebrook

MODEL 4841-1175

1633 SQUARE FEET • 3 BEDS / 2 BATHS



SIGNATURE KITCHEN WITH SURFACE COOK-TOP,  
BUILT-IN OVEN & MICROWAVE



DELUXE MASTER BATH W/ CORNER  
DECK TUB & 60" SHOWER



FURNACE & WATER HEATER LOCATION  
WITH STAIRWELL OPTION



STAIRWELL OPTION



OPTIONAL HALF-BATH IN UTILITY ROOM  
WITH FURNACE & WATER HEATER OMITTED OR  
RELOCATED TO LIKE STAIRWELL OPTION  
(AVAILABLE IN CRAWL SPACE SET HOMES ONLY)

# Stonebrook

**3/12 Roof Pitch** Craftsman Color Packages



**5/12 Roof Pitch** Craftsman Color Packages



**7/12 Roof Pitch** Craftsman Color Packages



## Typical Roof Pitch Selections

- 3/12, 5/12 and 7/12 Roof Pitch Available In All Models
- Renderings Displayed In Craftsman Exterior Color Packages A, B and C

# Brighton

MODEL 5028-32-5

1350 SQUARE FEET • 3 BEDS / 2 BATHS



SIGNATURE KITCHEN WITH SURFACE COOK-TOP, BUILT-IN OVEN & MICROWAVE



OPTIONAL ENTERTAINMENT CENTER

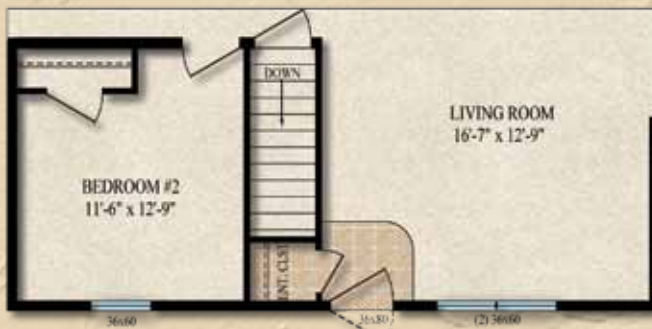

OPTIONAL BASEMENT STAIRWELL MOD ONLY



MASTER BATH OPTION w/ 60x43 SEAT SHOWER

# Aspen

MODEL 5228-404-1

1404 SQUARE FEET • 3 BEDS / 2 BATHS



DELUXE MASTER BATH OPTION  
w/ DECK TUB & 60x43 SEAT  
SHOWER



TRANSOM KITCHEN OPTION



MASTER BATH OPTION w/ 60x43  
SEAT SHOWER



BASEMENT STAIRWELL OPTION  
MOD ONLY

# Trenton

MODEL 5228-1149-1

1404 SQUARE FEET • 3 BEDS / 2 BATHS



OPTIONAL BASEMENT STAIRWELL w/ END ENTRY  
MOD ONLY



SIGNATURE KITCHEN WITH SURFACE COOK-TOP,  
BUILT-IN OVEN & MICROWAVE



END ENTRY OPTION



OPTIONAL BASEMENT STAIRWELL  
MOD ONLY



OPTIONAL MASTER BATH w/  
60x43 SEAT SHOWER

# Pheasant Ridge

MODEL 5228-75-1

1404 SQUARE FEET • 3 BEDS / 2 BATHS



Flex Bath Options  
A & C available  
(See Page #31)

# Diamondwood

MODEL 5428-49-3

1458 SQUARE FEET • 3 BEDS / 2 BATHS



DELUXE MASTER BATH w/ CORNER DECK TUB & 48" SHOWER



SIGNATURE KITCHEN WITH SURFACE COOK-TOP, BUILT-IN OVEN & MICROWAVE



BASEMENT STAIRWELL OPTION MOD ONLY



# Sheridan

MODEL 5628-92-2

1511 SQUARE FEET • 3 BEDS / 2 BATHS



OPTIONAL 1st EXTENSION  
SEE OPTION PAGE FOR LAAYOUTS  
(Page #31)

OPTIONAL 2nd EXTENSION  
W/ COTTAGE HIP OPTION



SIGNATURE KITCHEN OPTION WITH  
SURFACE COOK-TOP, BUILT  
IN OVEN & MICROWAVE



BASEMENT STAIRWELL OPTION  
MOD ONLY



OPTIONAL MASTER BATH w/  
60x43 SEAT SHOWER



DELUXE MASTER BATH  
OPTION w/ GARDEN TUB & 36"  
SHOWER

# Wyatt

5628-8045

1511 SQUARE FEET • 3 BEDS / 2 BATHS



OPTIONAL END ENTRY



SIGNATURE KITCHEN WITH SURFACE COOK-TOP,  
BUILT-IN OVEN & MICROWAVE



OPTIONAL BASEMENT  
STAIRWELL



OPTIONAL RECESSED ENTRY

## Keystone Exterior



# Meadow View

MODEL 5630-1012-1

1680 SQUARE FEET • 3 BEDS / 2 BATHS



OPTIONAL BASEMENT STAIRWELL  
MOD ONLY



OPTIONAL MASTER BATH w/  
CORNER DECK TUB & 36" SHOWER



SIGNATURE KITCHEN WITH . SURFACE COOK-TOP,  
BUILT-IN OVEN & MICROWAVE



OPTIONAL MASTER BATH w/ 60x43  
SEAT SHOWER

# Vandalia

MODEL 5630-1152

1680 SQUARE FEET • 3 BEDS / 2 BATHS



OPTIONAL 1/2 BATH IN UTILITY ROOM



SIGNATURE KITCHEN OPTION WITH  
SURFACE COOK-TOP, BUILT  
IN OVEN & MICROWAVE



DELUXE MASTER BATH OPTION



OPTIONAL BASEMENT STAIRWELL  
MOD ONLY

# Cedar Knoll

MODEL 6028-609-1

1620 SQUARE FEET • 3 BEDS / 2 BATHS



DELUXE MASTER BATH OPTION  
w/ DECK TUB & 60x43 SEAT SHOWER



TRANSOM KITCHEN OPTION



MASTER BATH OPTION w/ 60x43  
SEAT SHOWER



OPTIONAL BASEMENT STAIRWELL  
MOD ONLY



# Countryside

MODEL 6028-1157-1

1620 SQUARE FEET • 3 BEDS / 2 BATHS



OPTIONAL KITCHEN WITH ENTERTAINMENT CENTER

Flex Bath Options  
A, B, C, D & E  
available  
(See Page #31)



OPTIONAL BUMP-OUT & EXTENDED PORCH WITH SHED ROOF OVER PORCH



OPTIONAL BASEMENT STAIRWELL MOD ON1 V

# Sharonwood

MODEL 6428-406-1

1728 SQUARE FEET • 3 BEDS / 2 BATHS



DELUXE MASTER BATH OPTION  
w/ DECK TUB & 60x43 SEAT  
SHOWER



TRANSOM KITCHEN OPTION



OPTIONAL BASEMENT STAIRWELL  
MOD ONLY



MASTER BATH OPTION w/ 60x43  
SEAT SHOWER



# Arlington

MODEL 6428-12-1

1714 SQUARE FEET • 3 BEDS / 2 BATHS



DELUXE MASTER BATH OPTION



OPTIONAL BASEMENT STAIRWELL MOD ONLY



SIGNATURE KITCHEN OPTION WITH SURFACE COOK-TOP, BUILT IN OVEN & MICROWAVE



BEDROOM #3 WITH 20" BUMP-OUT OPTION



OPTIONAL 1/2 BATH

# Blairwood

MODEL 6430-43

1920 SQUARE FEET • 3 BEDS / 2 BATHS



SIGNATURE KITCHEN OPTION WITH  
SURFACE MOUNT RANGE, EYE LEVEL  
OVEN & BUILT IN MICROWAVE



DELUXE ISLAND OPTION  
(SHOWN WITH THE STD KITCHEN ALSO  
AVAILABLE IN THE SIGNATURE KITCHEN)



DELUXE MASTER BATH  
OPTION w/ DECK TUB AND  
48" SHOWER



BASEMENT STAIRWELL OPTION  
MOD ONLY

# Hartford

MODEL 6828-82-1

1725 SQUARE FEET • 3 BEDS / 2 BATHS



SIGNATURE KITCHEN WITH . SURFACE COOK-TOP, BUILT-IN OVEN & MICROWAVE



OPTIONAL BASEMENT STAIRWELL MOD ONLY



OPTIONAL MASTER BATH w/ CORNER DECK TUB & 48" SHOWER



OPTIONAL MASTER BATH w/ 60x43 SEAT SHOWER



OPTIONAL MASTER BATH w/ 60x43 SEAT SHOWER

# Knollwood

MODEL 7630-1173

2280 SQUARE FEET • 4 BEDS / 2 BATHS



DELUXE MASTER BATH w/ 60x43 SEAT SHOWER & DECK TUB



SIGNATURE KITCHEN OPTION WITH SURFACE COOK-TOP, BUILT IN OVEN & MICROWAVE

Flex Bath Options  
A, B, C, D & E available  
(See Page #31)



HOME OFFICE OPTION  
(REPLACES BEDROOM #4)



OPTIONAL BASEMENT STAIRWELL  
MOOD ONLY

# River Glen

MODEL 7630-35-1

2280 SQUARE FEET • 4 BEDS / 3 BATHS



HOME OFFICE OPTION  
(REPLACES RETREAT)



DEN OPTION  
(REPLACES RETREAT)



DINING ROOM OPTION  
(REPLACES RETREAT)



OPTIONAL BASEMENT STAIRWELL  
MOO ONLY



SIGNATURE KITCHEN WITH SURFACE COOK-TOP,  
BUILT-IN OVEN & MICROWAVE



OPTIONAL MASTER BATH w/  
CORNER DECK TUB & 48"  
SHOWER



OPTIONAL MASTER BATH w/ 60x41  
SEAT SHOWER



OPTIONAL LUXURY MASTER BATH w/  
CORNER DECK TUB & 48" SHOWER

# Carrington

MODEL 7630-1170-1

2280 SQUARE FEET • 3 BEDS / 2 BATHS



SIGNATURE KITCHEN WITH W/SURFACE COOK-TOP, BUILT-IN OVEN & MICROWAVE



BASEMENT STAIRWELL OPTION MUD ONLY



BEDROOM 4 OPTION (REPLACES WALK-IN CLOSET)



MASTER BEDROOM RETREAT OPTION (REPLACES WALK-IN CLOSET)



HOME OFFICE OPTION (REPLACES WALK-IN CLOSET)



OPTIONAL MASTER BATH w/ 60x33 SEAT SHOWER



DELUXE MASTER BATH w/ CORNER DECK TUB & 60" SHOWER



DELUXE MASTER BATH w/ 72" SOAKER TUB & 60" SHOWER

# Options

## 14' Extension Option



14' SUNROOM & PORCH ROOM



14' FAMILY ROOM & PORCH OPTION



14' FAMILY ROOM & MEDIA ROOM OPTION



14' MEDIA ROOM OPTION w/ HALF BATH AND PORCH

Note: Orientation of room may change depending on floor plan layout.

## Flex Bath Option



FLEX BATH OPTION "A"  
WITH A 60" CORNER TUB & 48" SHOWER



FLEX BATH OPTION "B"  
WITH A 72" SOAKER TUB & 48" SHOWER



FLEX BATH OPTION "C"  
WITH A 60x43 SEAT SHOWER



FLEX BATH OPTION "D"  
WITH A 72" SOAKER TUB & 48" SHOWER



FLEX BATH OPTION "E"  
WITH A 60" DECK TUB & 60x43 SEAT SHOWER

Note: Orientation of room may change depending on floor plan layout.

## Formal Foyer Option

(All Models)



OPTIONAL FORMAL FOYER



Your Local Home Builder:



437 North Main St. • Middlebury, IN 46540  
Phone: (574) 825-7500 • Fax: (574) 825-7569

[www.SchultHomes.com](http://www.SchultHomes.com)

October, 2011

**Clayton**  
homes